

First Phase Development

A New Urban Prototype

At the heart of RE:wild lies a simple yet powerful question: What does a modern, sustainable transformation of underused urban or suburban space look like? Guided by this inquiry, we closely studied the site's challenges and potential. Through careful analysis of its urban context and alignment with Turku's development goals, we designed a prototype for future urban growth—where densification goes hand-in-hand with green and blue infrastructure.

The first phase of development focuses on the central area, where key design principles are brought to life. Here, higher-density housing integrates with rewilding efforts and a forward-thinking, community-based approach to sustainable mobility.

On the eastern edge, the Mobility Hub serves as a gateway. It offers car-sharing, bike and e-bike services, making it easy for visitors arriving by car or public transit to switch to greener options. A large terraced urban square—centered around a water basin—invites playful interaction with water and introduces the site's overarching strategy: stormwater is made visible, functional, and engaging.

Adjacent to the hub, the Mobility Village combines low-rise residential buildings with ground-floor commercial spaces, activating the square and creating a lively, mixed-use neighborhood. Along Vähäheikkiläntie street, two residential blocks echo the scale of buildings across the road while remaining modest in height to respect the surrounding suburban character.

This cluster—the Mobility Hub, Mobility Village, and new residential buildings—also marks the beginning of the Adventure Path, a main pedestrian route that winds through the rewilded landscape. It guides visitors along the daylighted stream, revealing diverse habitats, local species, and sustainable stormwater strategies.

To the west, the rest of this first development phase is intentionally left unbuilt, allowing urban wilderness to thrive. Along the Adventure Path, visitors experience features such as rain gardens, riparian zones, and wet meadows—spaces that serve both as biodiversity hotspots and as stormwater retention areas during heavy rainfall.

RE:wild is more than a design—it's a living model for how cities like Turku can grow in balance with nature. With community life, climate resilience, and ecological health at its core, it reimagines urban development not just as expansion, but as regeneration.

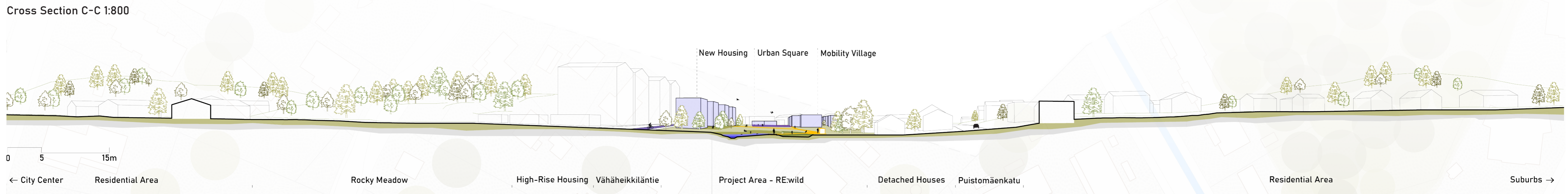

Mobility Meets Ecology

A vibrant square anchors this northern edge. The Adventure Path begins here, drawing a soft connection between the more urban areas and the wilder stream-side environments in the background. Permeable surfaces and a water-collecting basin are integrated into the square, making stormwater part of the visible, shared space. To the side, the Mobility Village frames the square with shops at street level. The Mobility Hub becomes a threshold, and acts as both a gateway and a gathering place, supporting local activity and setting the tone for the neighborhood.

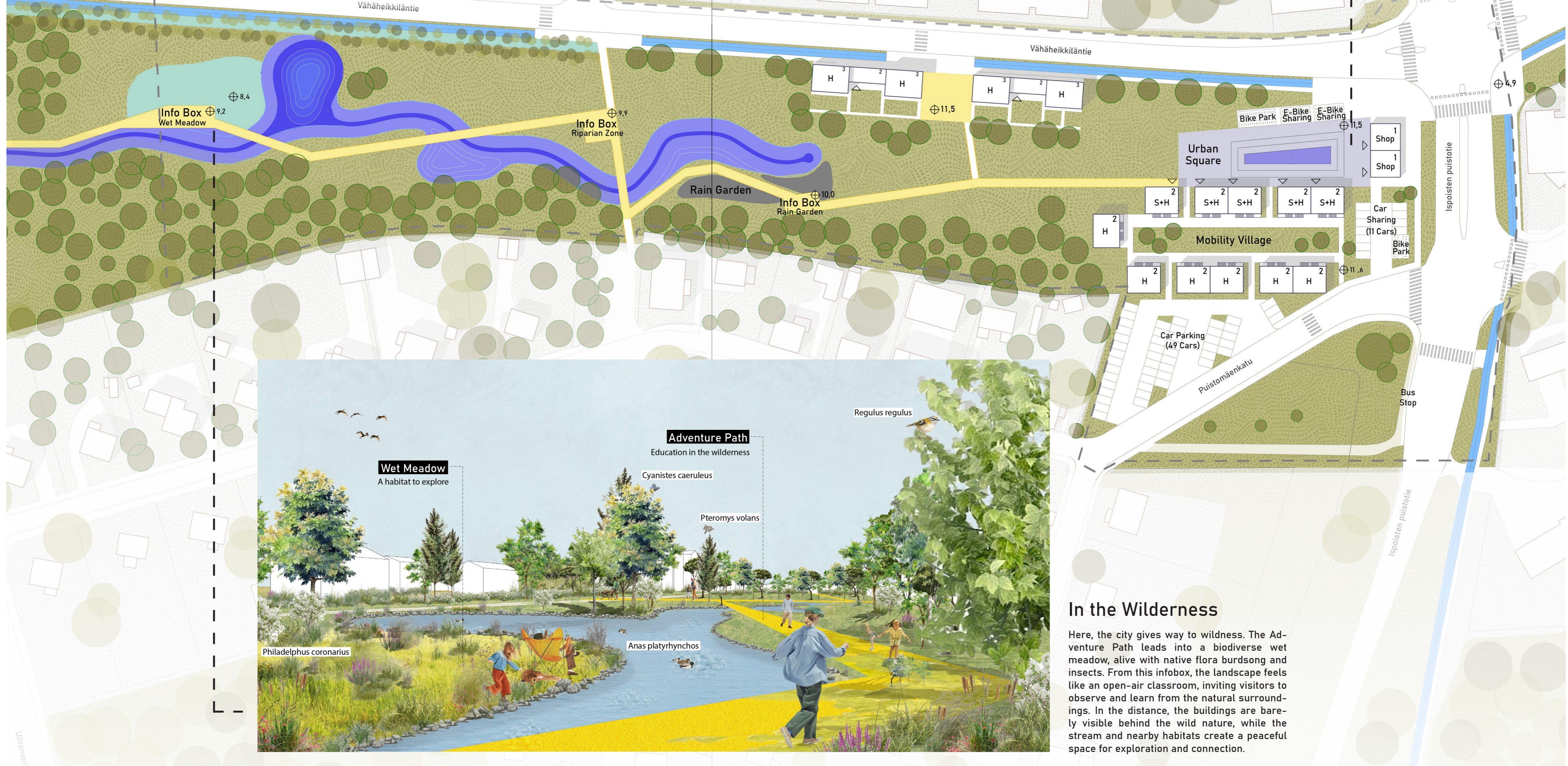
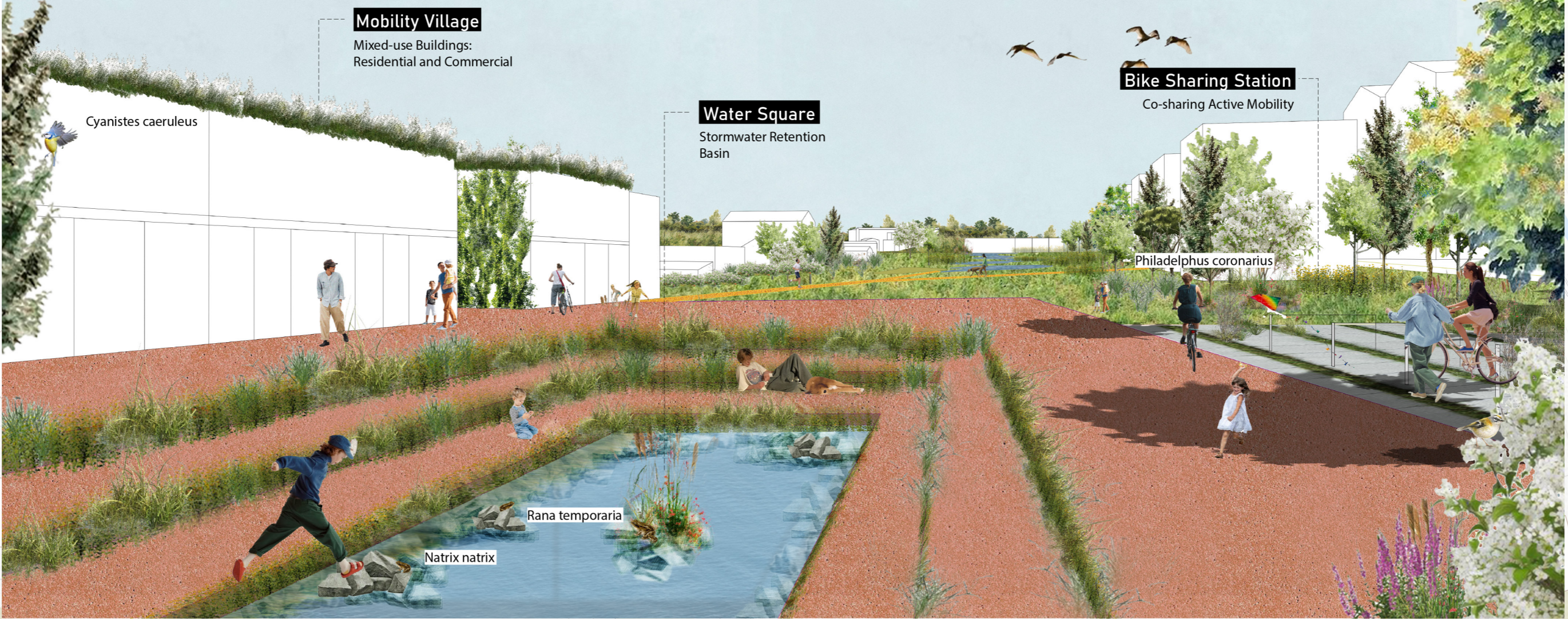

In the Wilderness

Here, the city gives way to wilderness. The Adventure Path leads into a biodiverse wet meadow, alive with native flora, birdsong and insects. From this infobox, the landscape feels like an open-air classroom, inviting visitors to observe and learn from the natural surroundings. In the distance, the buildings are barely visible behind the wild nature, while the stream and nearby habitats create a peaceful space for exploration and connection.