

AXONOMETRIC AXONOMETRY

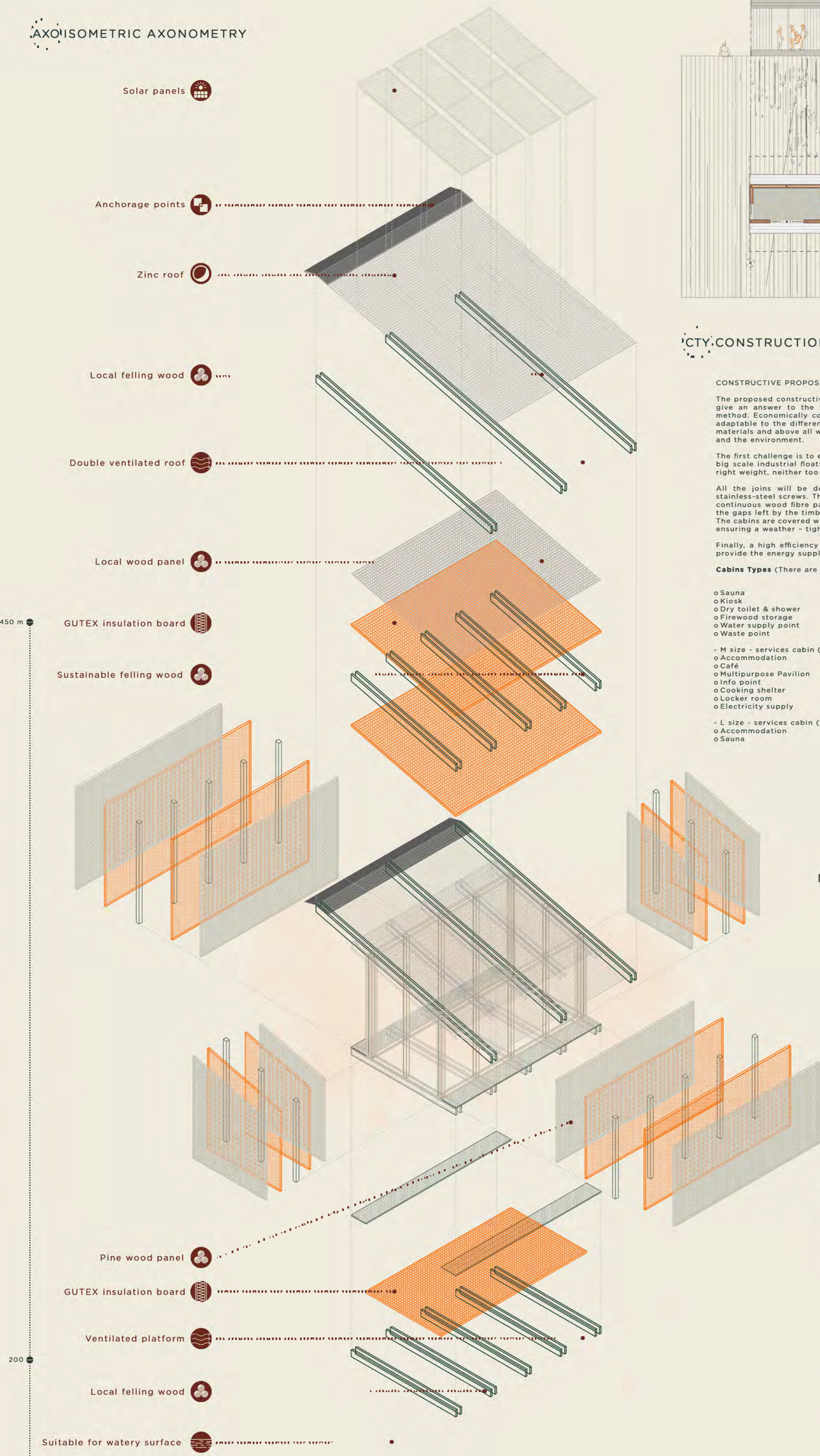

CITY CONSTRUCTION PROTOTYPE

CONSTRUCTIVE PROPOSAL

The proposed constructive system, according to the project strategy, intends to give an answer to the following criteria: An easy and fast dry construction method. Economically competitive, scalable, repeatable, reversible, flexible and adaptable to the different uses established in the brief. Using natural and local materials and above all with the less possible impact in the natural surroundings and the environment.

The first challenge is to ensure the stability of the different docks and cabins on big scale industrial floats. For that purpose, a local pine timber frame with the right weight, neither too heavy nor too light, is proposed.

Finally, a high efficiency solar panel power system is integrated on the roof to provide the energy supply to the whole system, in a clean and a respectful way.

Cabins Types (There are 3 different sizes of buildings, S, M and L)

- o Sauna
- o Kiosk
- o Dry toilet & shower
- o Firewood storage
- o Water supply point
- o Waste point
- M size - services cabin (42 m2)
- o Accommodation
- o Café
- o Multipurpose Pavilion
- o Info point
- o Cooking shelter
- o Locker room
- o Electricity supply
- L size - services cabin (150 m2)
- o Accommodation
- o Sauna

SMALL S

- Kiosk
- Sauna
- Dry toilet
- Firewood storage
- Water supply point
- Waste point

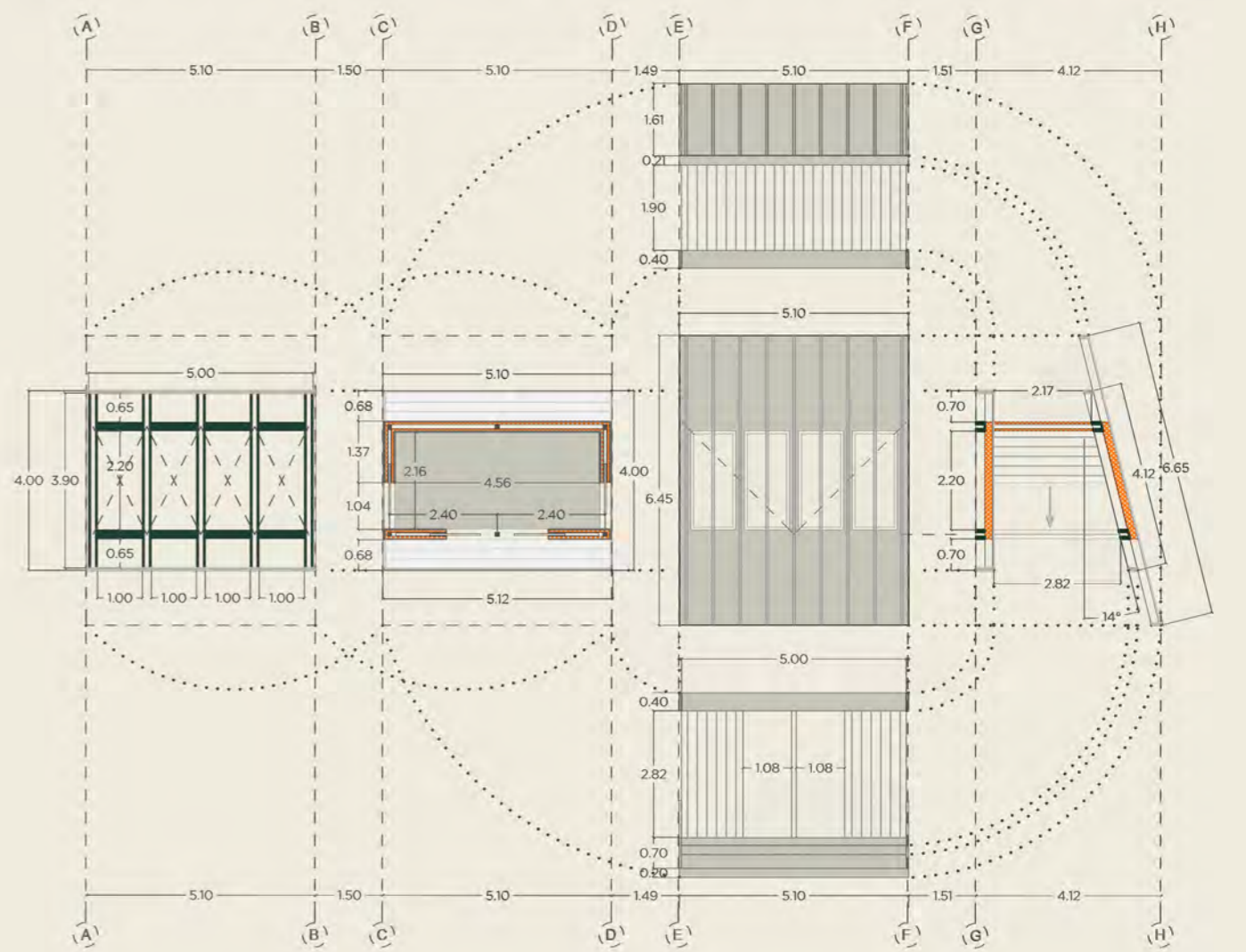

MEDIUM M

- Info point
- Café
- Accommodation
- Cooking shelter
- Multipurpose pavilion
- Locker room
- Electricity supply

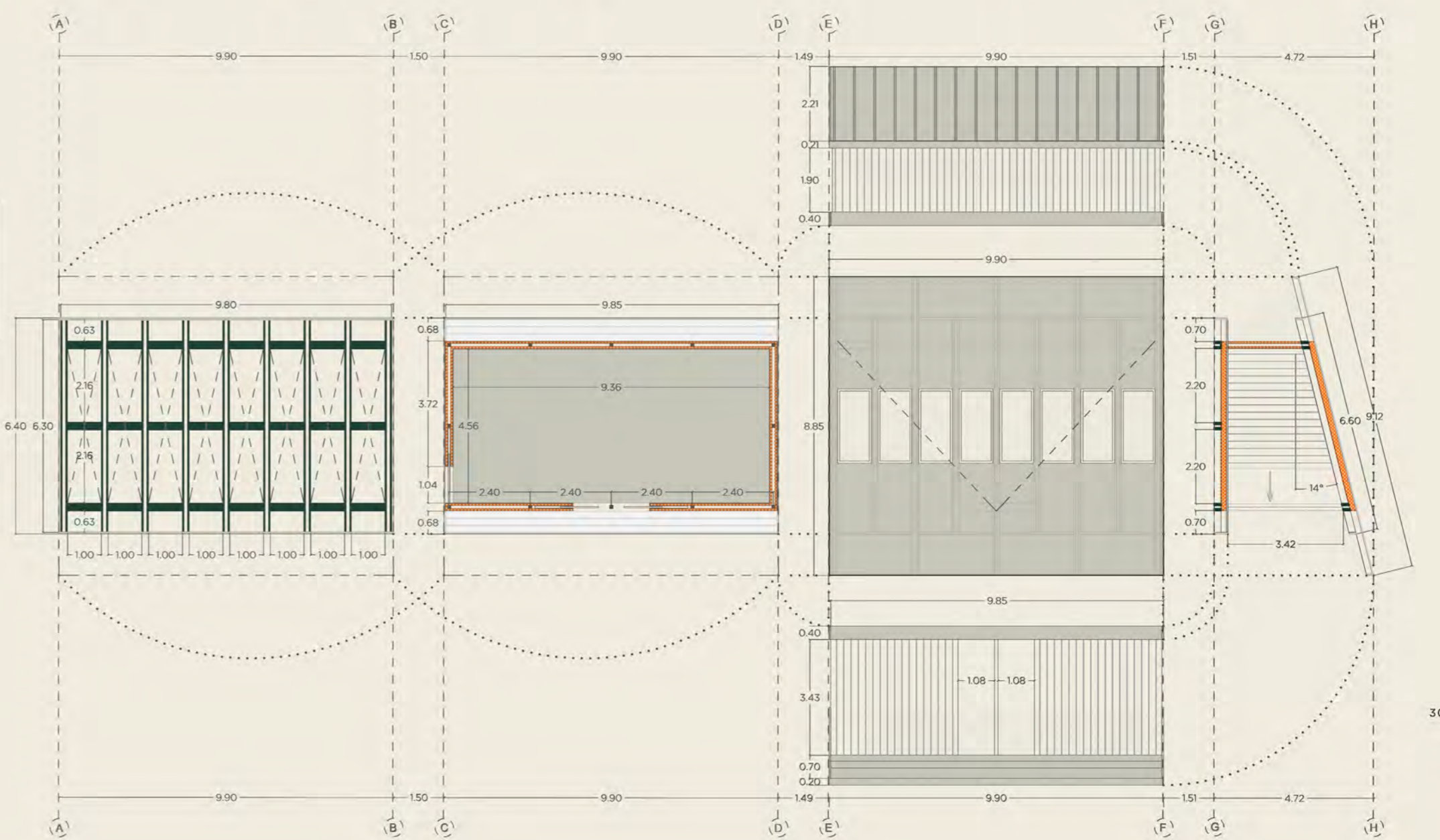

LARGE L

- Accommodation
- Sauna

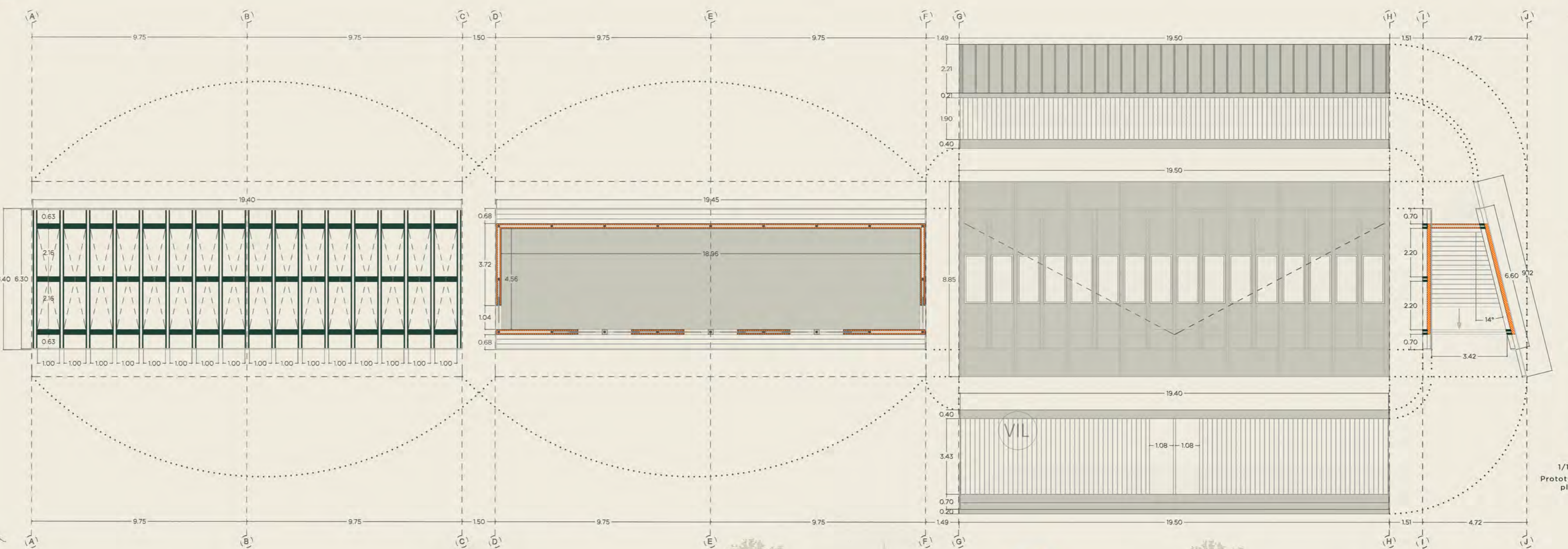

450 m
200
150
20
25
10
10
5
5
1
0
1/1000
Landing axes
General section

1
0
1/150
1/200
Prototype plan
Cabin junctions

